

A

DD Inline Desiccant Dryers



Features

- These desiccant dryers are a convenient and cost effective means of ensuring your sensitive pneumatic applications are never exposed to damaging moisture.
- Compact size for point-of-use applications.
- Recommended for Intermittent Usage
- Drying efficiency down to -40°F pressure dew point.
- Easily and quickly serviced.
- Sightglass in bowl to monitor desiccant.
- Built-in particulate after filter prevents downstream dust.
- No electricity needed.
- Low pressure drop.
- No purge air lost as with other dryer types.

Applications

- Paint Spraying
- Instrument Air
- Laboratory Instruments
- Control Air Systems
- Air Blanketing

Port Size	15 SCFM	30 SCFM	60 SCFM
Desiccant Capacity ¹	2.5 lb ¹	5 lb. ¹	10 lb. ¹
1/4" ²	DD15-02	N/A	N/A
3/8" ²	DD15-03	N/A	N/A
1/2" ²	DD15-04	DD30-04	DD60-04
3/4"	DD15-06	DD30-06	DD60-06
1"	N/A	DD30-08	DD60-08

Notes:

1. Desiccant must be ordered separately
2. These units supplied with reducer bushings

Performance

The rated flow capacities are nominal ratings provided for reference. These capacities are recommended for minimal pressure drop and average desiccant life. A supply of low flow / low humidity air will provide longer desiccant life: whereas, high flow / high humidity air will require more frequent desiccant changes. Installed in an application with intermittent flow, these desiccant dryers will typically dry air for weeks before the silica gel desiccant requires replacement or regeneration.

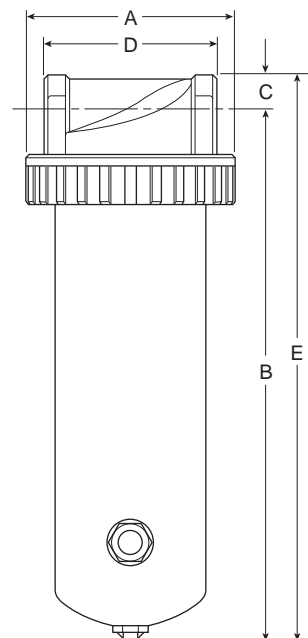

DD Desiccant Dryer Dimensions					
	A	B	C	D*	E
DD15	4.94 (125)	12.69 (322)	.84 (21)	4.06 (103)	13.5 (343)
DD30	4.94 (125)	22.44 (570)	.84 (21)	4.06 (103)	23.25 (591)
DD60	4.94 (125)	29.44 (748)	.84 (21)	4.06 (103)	30.25 (768)

* Dimension does not include reducer bushings for 1/4", 3/8", 1/2" versions

inches (mm)

As the wet compressed air enters through the inlet, the air travels down through the bed of desiccant which adsorb the water vapor and aerosols. The silica gel desiccant beads will reduce the humidity down to a -40°F pressure dew point. After the moisture has been removed, the dry air passes through a sintered bronze filter element (eliminating dust downstream), up the tube and out the outlet port.

As the desiccant becomes saturated with moisture, the dew point will begin to rise. This is evident when the blue silica gel desiccant beads in the sight glass change to pink, indicating the need for desiccant replacement. Simply remove the flange and bowl and replace with new desiccant or regenerate saturated desiccant by heating to 275°F.

Installation Tips

- Always place a moisture separator/particulate filter to remove bulk moisture **and** a coalescing filter to remove oil upstream of desiccant dryer. Desiccant coated with oil will not adsorb oil.
- Automatic drains should be used in prefilters
- A spring ball check valve should be installed at the dryer inlet to maximize the life of the desiccant.

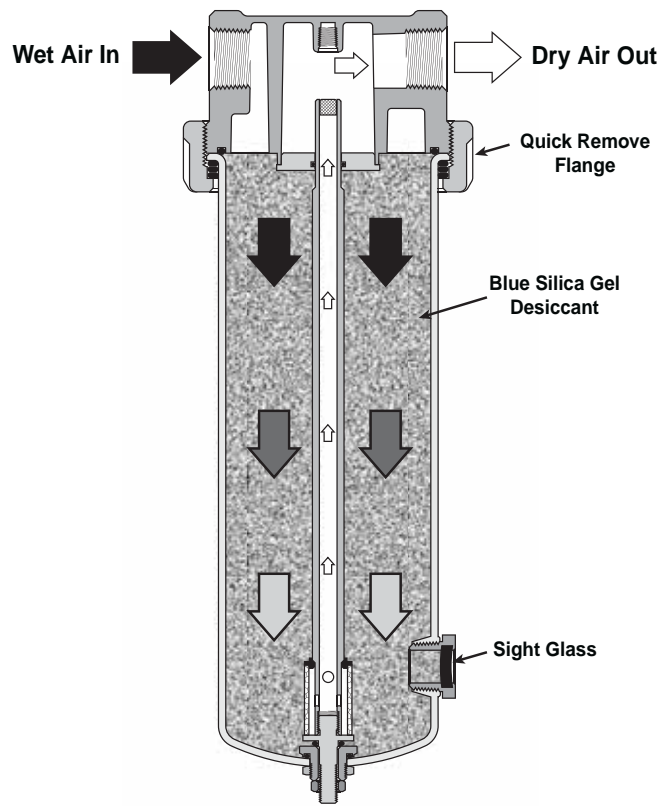

Desiccant Dryers Kits & Accessories

Desiccant - Silica Gel 100% Indicating –

(6) .88 lb. Bags	SGM100-1
(24) .88 lb. Bags	SGM100-4

Flow Tube Repair Kit (Tube, Filter Element(s), Adaptor)

DD15	RKDD15-02-06
DD30	RKDD30-03-08
DD60	RKDD60-03-08

Mounting Brackets (Recommended for DD15 & DD30 only) –

1/4 Inch Pipe Size (Pair of Pipe Mounted Brackets)	SA200YW57
1 Inch Pipe Size (Pair of Pipe Mounted Brackets)	SA200CW57

Spring Check Valve for Inlet (250 PSIG max.) –

(Maximizes Life of Desiccant)	
1/4 Inch NPT	003393001
3/8 Inch NPT	003393002
1/2 Inch NPT	003393003
3/4 Inch NPT	003393004

Specifications

Desiccant Capacity (Desiccant must be ordered separately) –

DD15	2.5 lb.
DD30	5 lb.
DD60	10 lb.

Filter Element Rating –

DD15, DD30	90 micron
DD60	40 micron

Pressure & Temperature Ratings –

Optimum working temperature	Below 100° F
Pressure Range	0 to 300 PSIG
Temperature Range	32°F to 180°F

Weight (Housing Only) –

DD15 (add 2.5 lb for weight full)	8 lb. (3.6 kg)
DD30 (add 5 lb for weight full)	13 lb. (5.9 kg)
DD60 (add 10 lb for weight full)	20 lb. (9.1 kg)

Materials of Construction

Bowl –

DD15, DD30	Aluminum
DD60	Steel

Flow Tube CPVC

Filter Elements Sintered Bronze

Head & Flange Ring Zinc

Other Hardware Brass

Seals Buna-N

Sight Glass Glass & Steel