

# Belt sanders

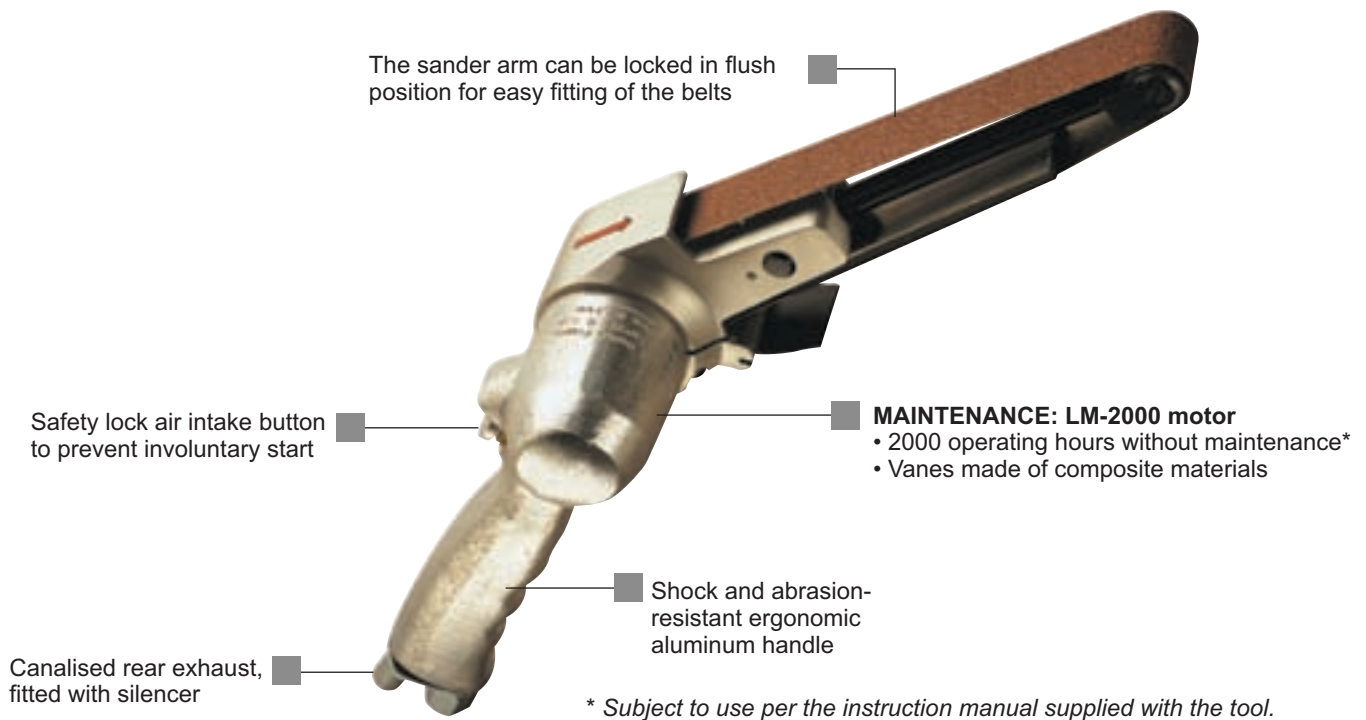

## Accessories

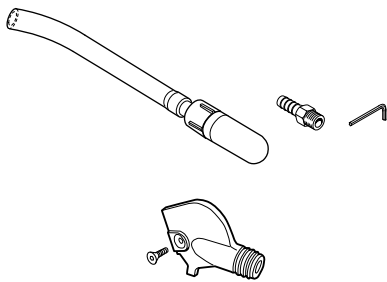
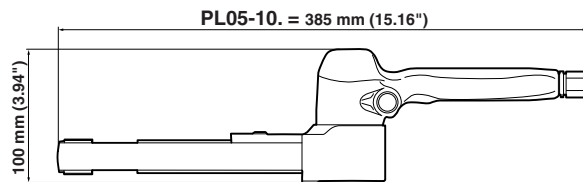

### PL05-10D / PL05-10E / PL05-10F

#### ACCESSORIES INCLUDED

	PART NO.
• Exhaust hose	615 396 022 0
• 1/4" air hose nipple for 6mm (1/4") ID hose	615 705 009 0
• Hex. key 4 mm	615 802 054 0

#### OPTIONAL ACCESSORIES

	PART NO.
• Suction cap for 32mm (1 1/4") ID vacuum hose	321003
• Screw FHc M4x10	615 616 118 0

#### OPTIONAL ACCESSORIES

##### COATED ABRASIVE BELTS

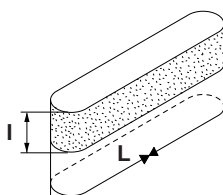

L x l		GRIT NUMBER				
mm	in.	P40	P50	P60	P90	P100
480 x 16	18 7/8 x 5/8	615 848 313 0	615 848 314 0	615 848 315 0	615 848 316 0	615 848 317 0
480 x 20	18 7/8 x 25/32	615 848 323 0	615 848 324 0	615 848 325 0	615 848 326 0	615 848 327 0
480 x 25	18 7/8 x 63/64	615 848 333 0	615 848 334 0	615 848 335 0	615 848 336 0	615 848 337 0

L x l		GRIT NUMBER			
mm	in.	P120	P150	P190	P240
480 x 16	18 7/8 x 5/8	615 848 318 0	615 848 319 0		
480 x 20	18 7/8 x 25/32	615 848 328 0	615 848 329 0	615 848 320 0	
480 x 25	18 7/8 x 63/64	615 848 338 0	615 848 339 0	615 848 330 0	615 848 331 0

# Belt sanders

300 Watts (0.4 hp) - 16000 rpm



**A**



**B**



**C**



**Caution:** comply with the speeds recommended by component and abrasive manufacturers.

PIC REF	MODEL	PART NUMBER	FREE SPEED	BELT SIZE L x l		POWER		WEIGHT		AIR CONSUMPTION AT FREE SPEED		AIR INLET THREAD	HOSE INT. Ø	
				rpm	mm	in.	W	hp	kg	lb	l/s	cfm	in.	mm
A	PL05-10D	615 170 131 0	16000	480 x 16	18 <sup>7</sup> / <sub>8</sub> x 5 <sup>1</sup> / <sub>8</sub>	300	0.4	1.2	2.6	12	25.4	1/4	6	1/4
B	PL05-10E	615 170 132 0	16000	480 x 20	18 <sup>7</sup> / <sub>8</sub> x 25 <sup>1</sup> / <sub>32</sub>	300	0.4	1.2	2.6	12	25.4	1/4	6	1/4
C	PL05-10F	615 170 133 0	16000	480 x 25	18 <sup>7</sup> / <sub>8</sub> x 63 <sup>1</sup> / <sub>64</sub>	300	0.4	1.2	2.6	12	25.4	1/4	6	1/4