

Routers

375 to 900 Watts (0.5 to 1.21 hp) - 12000 to 40000 rpm

375 W (0.5hp) - 20000 to 40000 rpm

CNOMO type collet



A

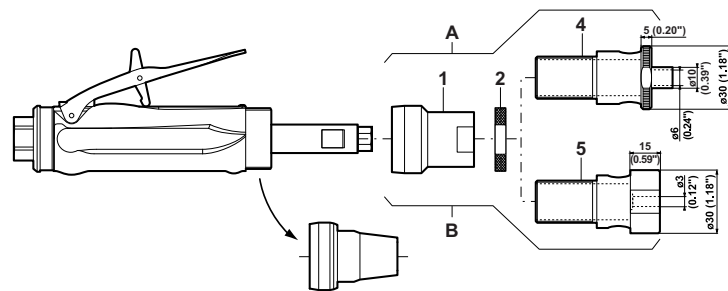

615 396 069 0: Machined routing kit for burr, max \varnothing 6.4mm (1/4")

615 396 070 0: Blank routing kit allowing you to adapt the blank to fit the application

600 - 900 W (0.8 - 1.21hp) - 12000 to 28000 rpm

CNOMO type or Series 200 collet



B

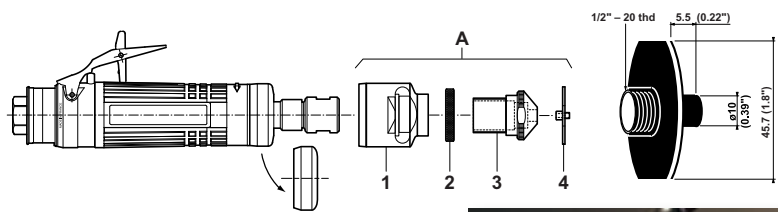

615 396 289 0: Machined routing kit for burr, max \varnothing 6.4mm (1/4")

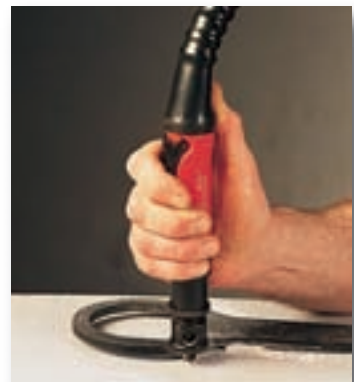

OPTIONAL ACCESSORIES

ITEM	KC3..	KC6../KC9..
A Machined routing kit	615 396 069 0	615 396 289 0
B Blank routing kit (item 1, 2, 5)	615 396 070 0	
1 Flange	615 595 231 0	615 595 245 0
2 Adjusting nut	615 607 140 0	615 607 145 0
• Circlip		615 687 056 0
• Bearing		615 758 127 0
3 Router nose (including: circlips & bearing)		615 542 132 2
4 Machined routing guide	615 542 125 0	615 542 131 0
5 Blank routing guide	615 542 125 2	

If you need a complete tool use the KC624-9RT (24000 rpm) Part No. 615 170 290 0

If you need a specific speed or a higher power:

Select the motor, the speed of your choice below then add the routing kit.

For example: Tool with Series 200 collet - 900 W -22000 rpm (KC922-9) + routing kit **Order 615 170 160 0 + 615 396 289 0**

Caution: comply with the speeds recommended by component and abrasive manufacturers.

PIC REF	MODEL	FREE SPEED	POWER		PART NO.		ROUTING KIT		
			rpm	W	hp	CNOMO COLLET (-7)	SERIES 200 COLLET (-9)	MACHINED	BLANK
375 Watts (0.5 hp) - CNOMO type collet									
A	KC340-7	40000	375	0.5	615 170 032 0		+	615 396 069 0	615 396 070 0
A	KC331-7	31000	375	0.5	615 170 031 0		+		
A	KC325-7	25000	375	0.5	615 170 030 0		+		
A	KC320-7	20000	375	0.5	615 170 029 0		+		
600 - 900 Watts (0.8 - 1.21 hp) - CNOMO type or Series 200 collet									
B	KC628-	28000	600	0.80	615 170 126 0	615 170 158 0	+	615 396 289 0	
B	KC624-	24000	600	0.80	615 170 125 0	615 170 159 0	+		
B	KC922-	22000	900	1.21	615 170 130 0	615 170 160 0	+		
B	KC619-	19000	600	0.80	615 170 124 0	615 170 161 0	+		
B	KC918-	18000	900	1.21	615 170 129 0	615 170 162 0	+		
B	KC615-	15000	600	0.80	615 170 123 0	615 170 163 0	+		
B	KC915-	15000	900	1.21	615 170 128 0	615 170 164 0	+		
B	KC912-	12000	900	1.21	615 170 127 0	615 170 165 0	+		

Collet Grinder Accessories

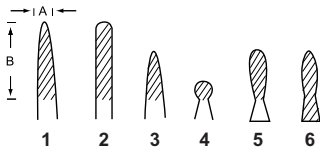

Tungsten Carbide Burrs are suitable for cutting unhardened and hardened steels, stainless, weld seams, steel castings, light and non-ferrous metals, plastics.

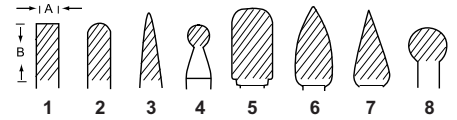

TUNGSTEN CARBIDE BURRS 3mm Ø SHANK

Can also be used with collet type CNOMO or 200 & 300 Series (1/8")

PIC REF	A		B		PART NO.
	mm	in.	mm	in.	
1	3	1/8	13	1/2	38122
2	3	1/8	13	1/2	38132
3	3	1/8	8	5/16	38142
4	3	1/8	3	1/8	38152
5	3	1/8	8	5/16	38162
6	3	1/8	8	5/16	38172

TUNGSTEN CARBIDE BURRS 6mm Ø SHANK

Can also be used with collet type CNOMO or 200 & 300 Series (1/4")

PIC REF	A		B		PART NO.
	mm	in.	mm	in.	
1	6	1/4	13	1/2	38182
2	6	1/4	16	5/8	38192
3	6	1/4	19	3/4	38202
4	6	1/4	6	1/4	38222
5	10	3/8	19	3/4	36122
6	10	3/8	19	3/4	36132
7	10	3/8	19	3/4	36142
8	10	3/8	10	3/8	38232

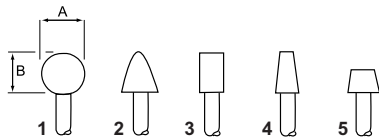

Aluminium Oxide Mounted Points are available in red grades. Red grades are suitable for grinding high tensile materials such as ordinary and alloy steels, high speed steel and annealed malleable iron.

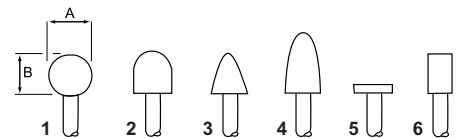

MOUNTED POINTS 3mm Ø SHANK - RED

Can also be used with collet type CNOMO or 200 & 300 Series (1/8")

PIC REF	MAX SPEED	A		B		PART NO.
		mm	in.	mm	in.	
1	104000	5	0.19	5	0.19	38582
2	104000	5	0.19	8	0.31	38522
3	81000	6	0.25	6	0.25	38632
4	105000	4	0.16	4	0.16	38562
5	81000	6	0.25	6	0.25	38542

MOUNTED POINTS 6mm Ø SHANK - RED

Can also be used with collet type CNOMO or 200 & 300 Series (1/4")

PIC REF	MAX SPEED	A		B		PART NO.
		mm	in.	mm	in.	
1	59000	16	0.62	16	0.62	435983
2	50000	20	0.79	16	0.62	435993
3	45000	20	0.79	28	1.10	436003
4	48000	20	0.79	32	1.26	436013
5	53000	20	0.79	22	0.87	436023
6	40000	13	0.51	25	1.00	436033
6	38000	25	1.00	3	0.11	436043

RECOMMENDED SPEEDS FOR TUNGSTEN CARBIDE BURRS - rpm x 1000

MATERIAL	HEAD DIAMETER				
	3mm (1/8")	6mm (1/4")	10mm (3/8")	13mm (1/2")	16mm (5/8")
Alum, Zinc Base, Plastics	30-90	15-70	10-50	17-38	6-30
Cast Iron, Brass, Copper, Bronze	45-90	23-60	15-40	11-30	9-24
Mild Steel	60-90	45-60	30-40	22-30	18-24
Titanium, Stainless, Hardened Steels, Ceramics	60-90	30-45	19-30	15-22	12-18

BACKING PAD WITH 6mm Ø SHANK



SPEED	Ø		PART NO.
rpm	mm	in.	
25000	50	1.97	615 804 098 0



ABRASIVE DISCS

SPEED	GRIT	PART NO.
rpm		
25000	P40	615 804 099 0
25000	P60	615 804 100 0
25000	P80	615 804 101 0
25000	P120	615 804 102 0