

# Tappers



A



B



C



D

Accessories: see page 268

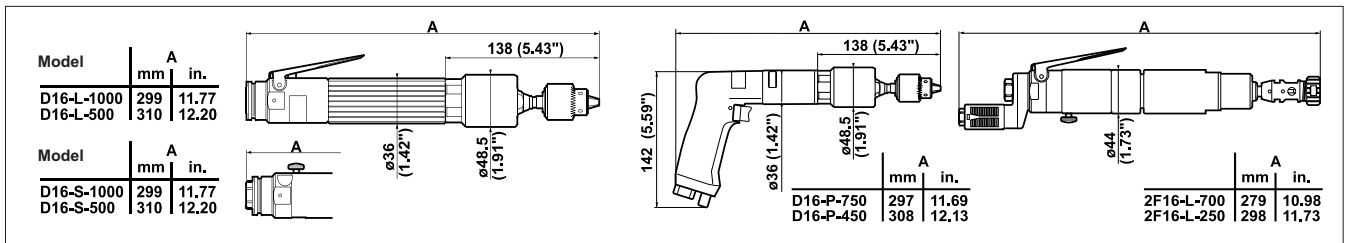

PIC REF	MODEL	PART NUMBER	FREE SPEED	REVERSE SPEED	CHUCK SIZE		MAX. TAPPING TORQUE		WEIGHT		AIR FLOW		AIR INLET	HOSE INT. Ø	
			rpm	rpm	mm	in.	N.m	ft.lb	kg	lb	l/s	cfm	in.	mm	in.

## D SERIES

Button Start – push/pull reverse

A	D16-S-1000	1274544	1000	2000	6.5	1/4	4.3	3.17	1.3	2.86	9.4	19.9	1/4	10	3/8
A	D16-S-500	1274384	500	1000	10.0	3/8	8.6	6.34	1.4	3.08	9.4	19.9	1/4	10	3/8

Lever Start – push/pull reverse

B	D16-L-1000	1274624	1000	2000	6.5	1/4	4.3	3.17	1.3	2.86	9.4	19.9	1/4	10	3/8
B	D16-L-500	1274464	500	1000	10.0	3/8	8.6	6.34	1.4	3.08	9.4	19.9	1/4	10	3/8

Trigger Start – push/pull reverse

C	D16-P-750	1288084	750	1500	6.5	1/4	6.2	4.57	1.7	3.75	8.5	18.0	1/4	10	3/8
C	D16-P-450	1287934	450	900	10.0	3/8	11.1	8.18	1.8	3.97	8.5	18.0	1/4	10	3/8

## F SERIES

Lever Start – button reverse – stand mounted

D	2F16-L-700	1241394	700	700	6.5	1/4	6.7	4.94	1.7	3.75	11.1	23.5	1/4	10	3/8
D	2F16-L-250	1241474	250	250	6.5	1/4	17.5	12.90	1.8	3.97	11.1	23.5	1/4	10	3/8



E

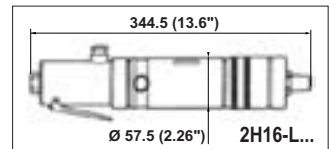

PIC REF	MODEL	PART NUMBER	LOW SPEED SETTING	HIGH SPEED SETTING	MAX. TAPPING TORQUE		WEIGHT		AIR FLOW		AIR INLET	HOSE INT. Ø	
			rpm	rpm	N.m	ft.lb	N.m	ft.lb	kg	lb	l/s	cfm	in.

## H SERIES

Lever Start - button reverse - stand mounted

E	2H16-L-250/800 - B16	1452444	250	800	90	66.4	29	21.4	3.1	6.8	15.6	33	3/8	10	3/8
E	2H16-L-250/800 - B18	1434184	250	800	90	66.4	29	21.4	3.1	6.8	15.6	33	3/8	10	3/8
E	2H16-L-160/500 - B18	1434264	130	500	140	103.3	47	34.7	3.1	6.8	15.6	33	3/8	10	3/8
E	2H16-L-90/250 - B18	1434344	90	250	240	177.0	90	66.4	3.1	6.8	15.6	33	3/8	10	3/8

# Accessories

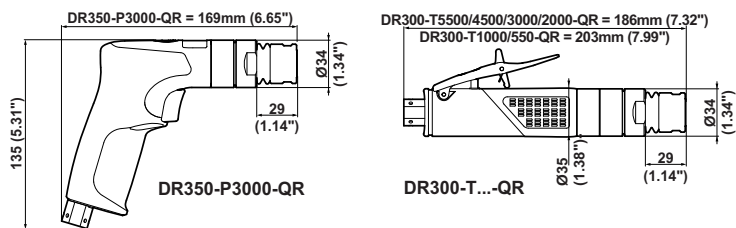

## DR350-P3000-QR / DR300-T550/1000/2000/3000/4500/5500-QR

### ACCESSORIES INCLUDED

ITEM	205 050 331 3 205 050 329 3 205 050 333 3 205 050 335 3	ANGLE HEAD 205 050 338 3 205 050 341 3	205 050 353 3	DRILLS DR300
• ø 4.8mm (3/16") capacity collet	2552	19182	615 526 088 0	
• ø 6.4mm (1/4") capacity collet				205 050 299 3
• ø 8mm (5/16") capacity collet				205 050 288 3
1 Short lever				205 050 045 3
2 Safety lever				205 049 446 3
3 Inlet button (with lever recess plugs)				205 050 746 3
4 Side handle (for DR300-T550/1000/2000/3000)				
• Exhaust hose (with clamping)	268263	82623		
• Wrench 8-9mm (Qty 2)				
• Wrench 10mm				

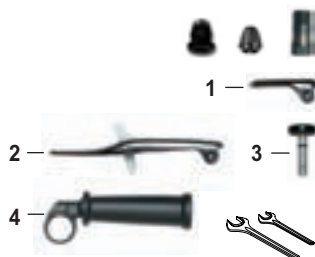

### OPTIONAL ACCESSORIES

ITEM	PART NO.
4 Side handle	205 049 446 3



Collet Capacity	205 050 331 3 205 050 329 3 205 050 333 3 205 050 335 3	205 050 338 3 205 050 341 3	205 050 353 3	Collet Capacity	205 050 331 3 205 050 329 3 205 050 333 3 205 050 335 3	205 050 338 3 205 050 341 3	205 050 353 3
	A	B	C		A	B	C
• ø 1.0mm	2172			• ø 3.9mm	2462		
• ø 1.1mm	2182			• ø 4.0mm (5/32")	2472	19052	615 526 071 0
• ø 1.2mm	2192			• ø 4.1mm	2482		
• ø 1.3mm	2202			• ø 4.2mm	2492	19062	
• ø 1.4mm	2212			• ø 4.3mm	2502		
• ø 1.5mm	2222			• ø 4.4mm	2512	19072	
• ø 1.6mm	2232	18922		• ø 4.5mm	2522		615 526 073 0
• ø 1.7mm	2242			• ø 4.6mm	2532	19082	
• ø 1.8mm	2252	18932		• ø 4.7mm	2542		
• ø 1.9mm	2262			• ø 4.8mm (3/16")	2552	19092	
• ø 2.0mm	2272	18942	615 526 066 0	• ø 4.9mm	2562		
• ø 2.1mm	2282			• ø 5.0mm	2572	19102	615 526 075 0
• ø 2.2mm	2292	18952		• ø 5.2mm		19122	
• ø 2.3mm	2302			• ø 5.4mm		19132	615 526 077 0
• ø 2.4mm (3/32")	2312			• ø 5.5mm			615 526 077 0
• ø 2.5mm	2322		615 526 068 0	• ø 5.6mm		19142	
• ø 2.6mm	2332	18972		• ø 5.8mm		19152	
• ø 2.7mm	2342			• ø 6.0mm		19162	615 526 079 0
• ø 2.8mm	2352	18982		• ø 6.2mm		19172	
• ø 2.9mm	2362			• ø 6.4mm		19182	
• ø 3.0mm	2372	18992	615 526 069 0	• ø 6.5mm			615 526 081 0
• ø 3.1mm	2382			• ø 7.0mm			615 526 083 0
• ø 3.2mm (1/8")	2392	19002		• ø 7.5mm			615 526 084 0
• ø 3.3mm	2402			• ø 8.0mm			615 526 088 0
• ø 3.4mm	2412	19022		• ø 1/16"	91442		
• ø 3.5mm	2422		615 526 070 0	• ø 3/32"	91452		
• ø 3.6mm	2432	19032		• ø 1/8"	91462		
• ø 3.7mm	2442			• ø 5/32"	91472		
• ø 3.8mm	2452	19042		• ø 3/16"	91482		



### CHUCK MOUNTING

3/8" x 24 tpi

205 050 543 3

- Chuck threaded 3/8" UNF cap. 8mm (5/16") (with key)
- Keyless Chuck threaded 3/8" UNF- cap. 8mm (5/16")

205 053 013 3

473433