

## Field-Attachable Connectors

**BCC A334-0000-10-000-71X4A5-000**

**Order Code: BCC0708**

# BALLUFF

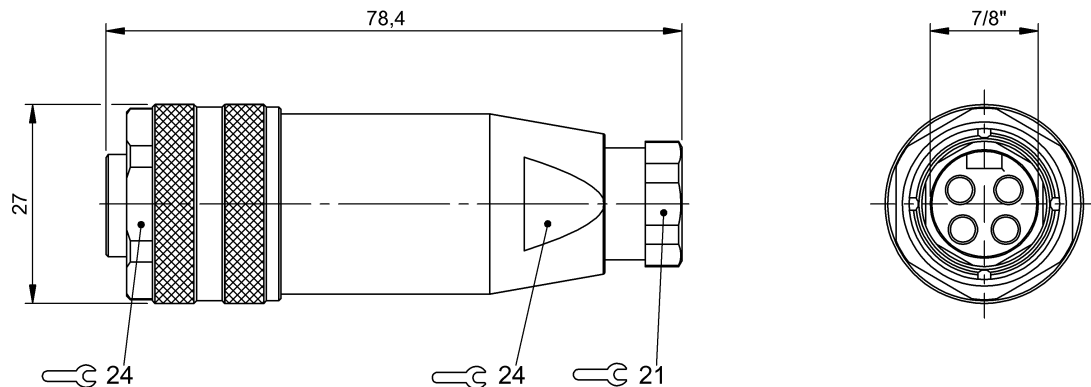

### Basic features

Approval/Conformity	CE cURus EAC WEEE
---------------------	----------------------------

### Electrical connection

Cable diameter D	10...12 mm
Connection	7/8"-16 UN-Female, Straight, 4-pin
Number of connectable contacts	4
System	Can be fabricated

### Electrical data

Operating voltage $U_b$	600 VDC / 600 VAC
Rated current (40 °C)	9.0 A

### Remarks

Enclosure rating per IEC 60529, only in screwed state with the associated mating piece.

### Environmental conditions

Ambient temperature	-25...85 °C
IP rating	IP67

### Material

Material contact carrier	PUR, PA
Material contacts	Brass
Material cover nut	Die-cast zinc
Material grip	PBT

### Mechanical data

Connection cross-section	0.14...1.5 mm <sup>2</sup>
Tightening torque pigtail	1.5 Nm
Type of wire mounting	Screw terminals

## Connector Drawings

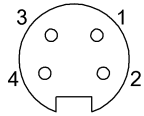

PIN 1-4 usable